

J4 BODY

WHEELBASE : 242MM
FOR CMX · CFX SERIES

MST
MAX SPEED TECHNOLOGY

1

◀ TRIMMING

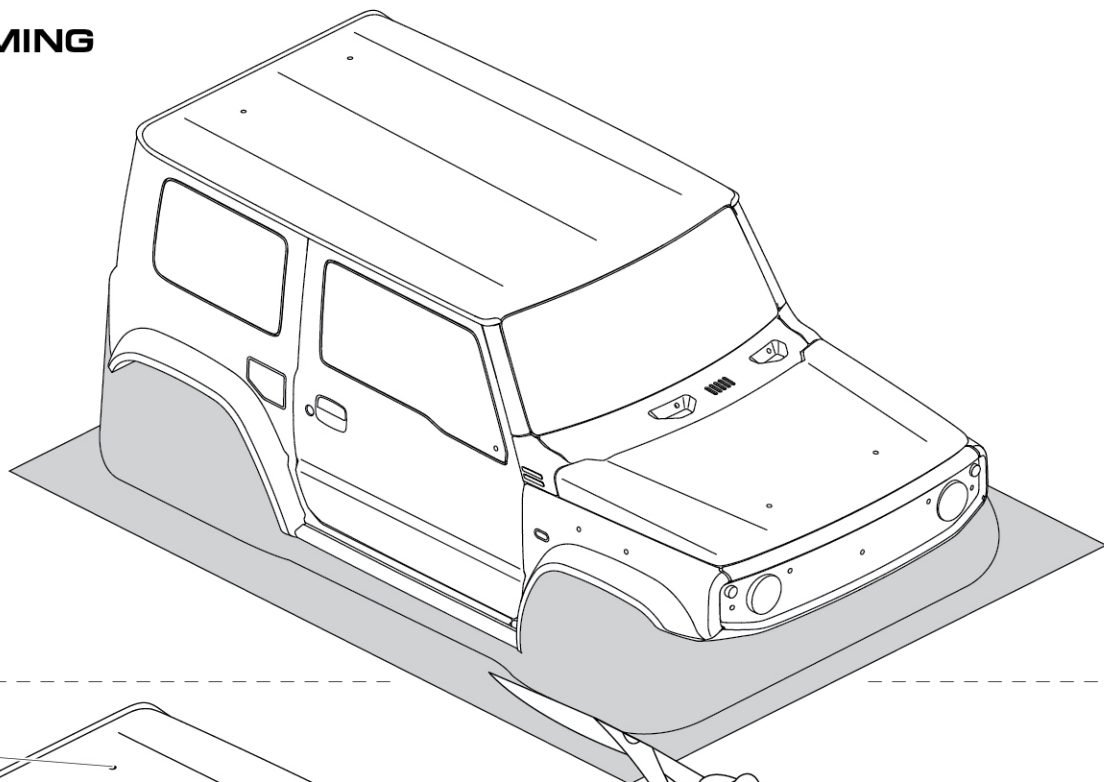

Make 5.5mm holes

Make 2mm holes

Make 5.5mm holes

Make 5.5mm holes

Make 2.5mm holes

Make 5.5mm holes

2

◀ WASH THE BODY

※ Wash the body thoroughly with detergent
in order to remove oil completely rinse and
place to air dry.



3

MASKING AND PAINTING



※ Please apply the masking stickers to the car inside exactly before painting.

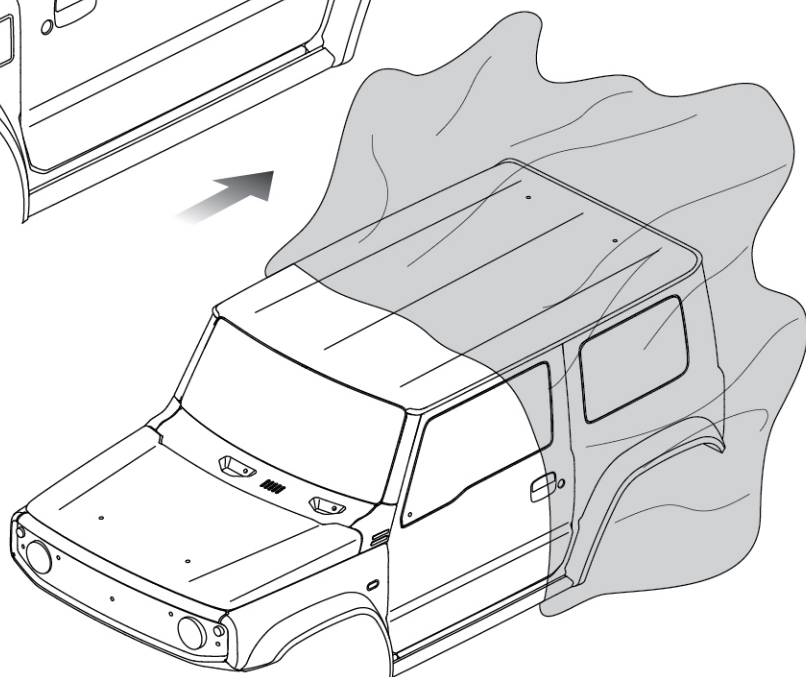
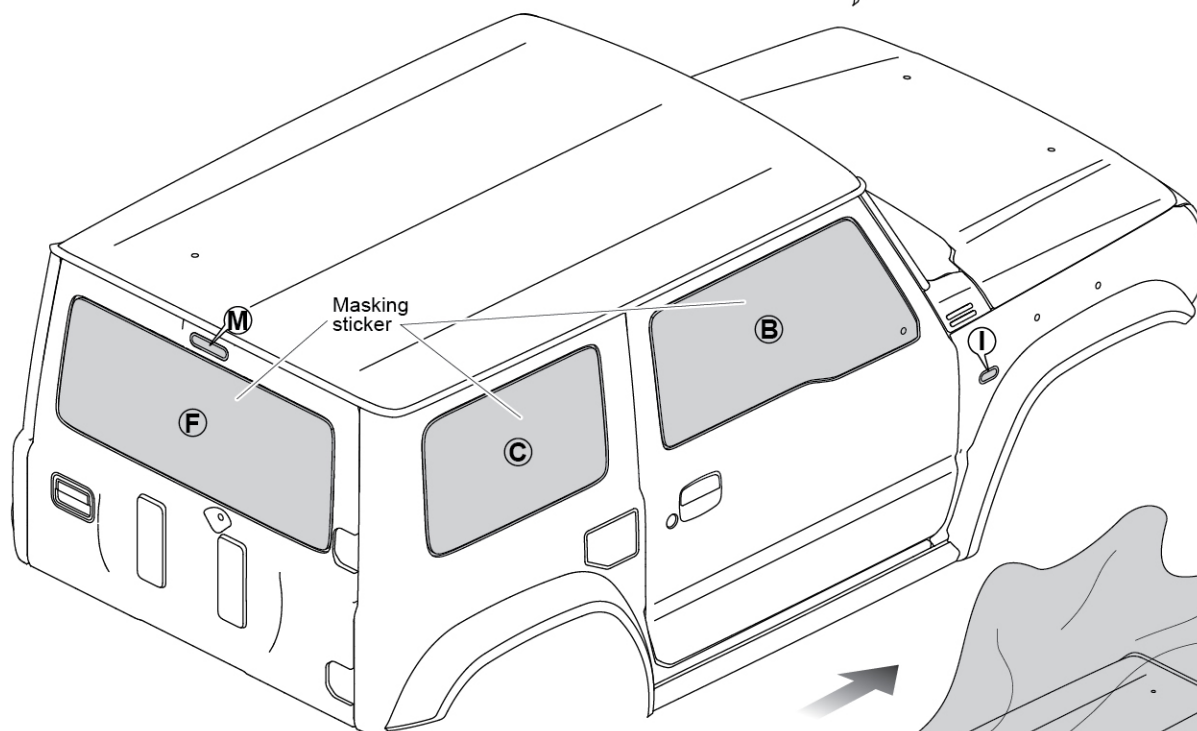
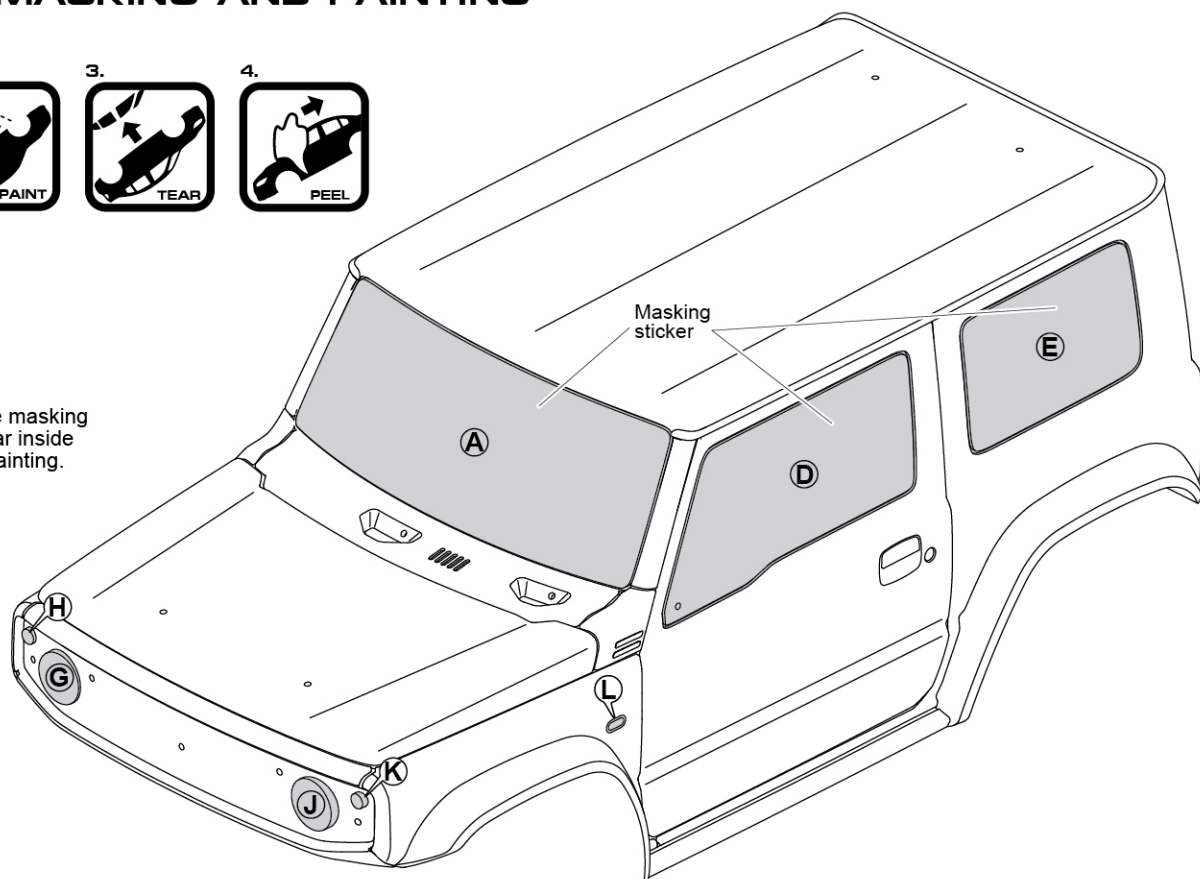

※ Remove the masking stickers after the finish of painting. Then remove the car outside protecting film before acting the next step.

4

MARKINGS



※ Please moisturize the sticker by the suds in advanced.



※ Then use a hair dryer for heating when sticking.

⚠ Apply stickers in numbered order.

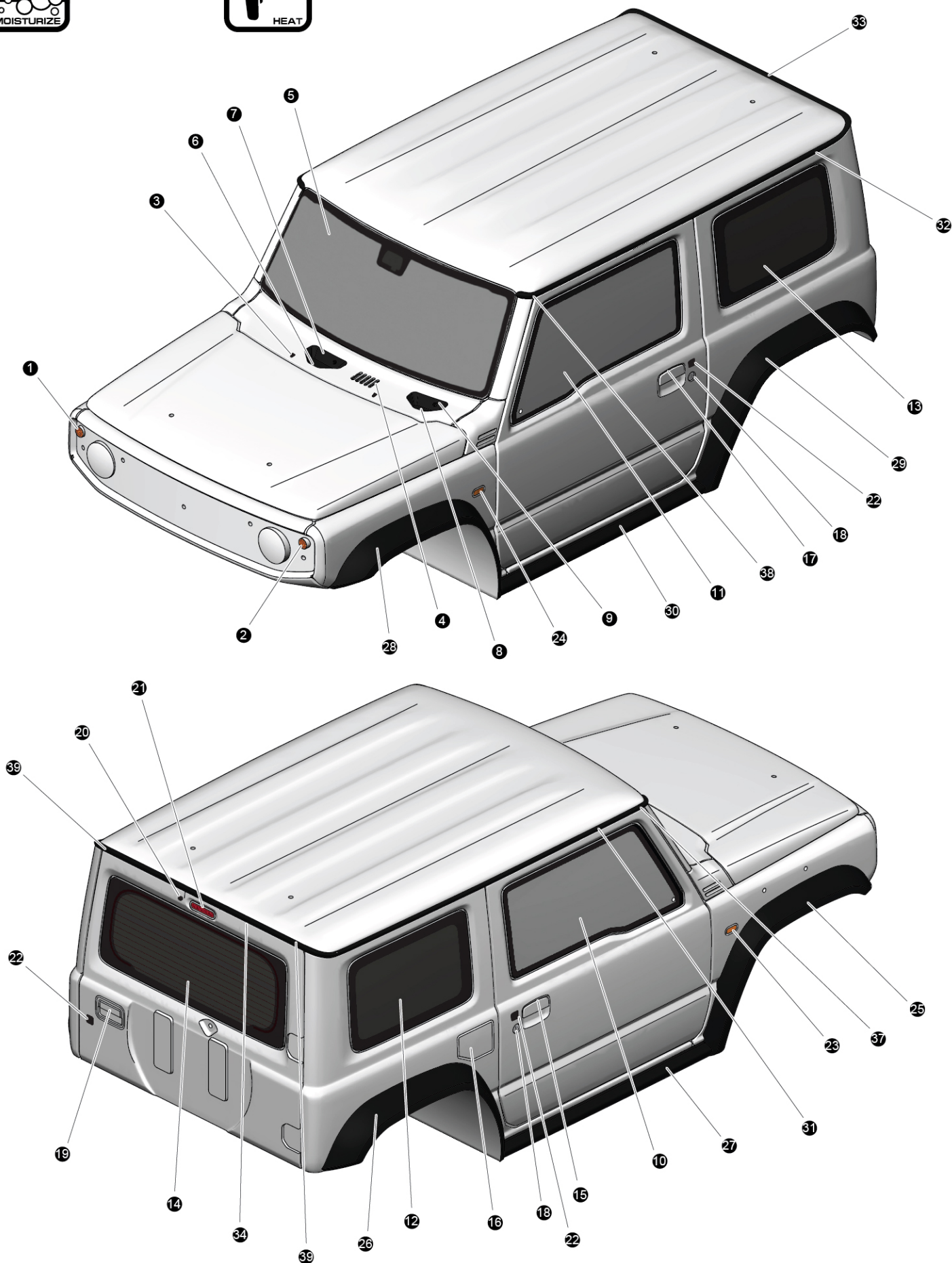

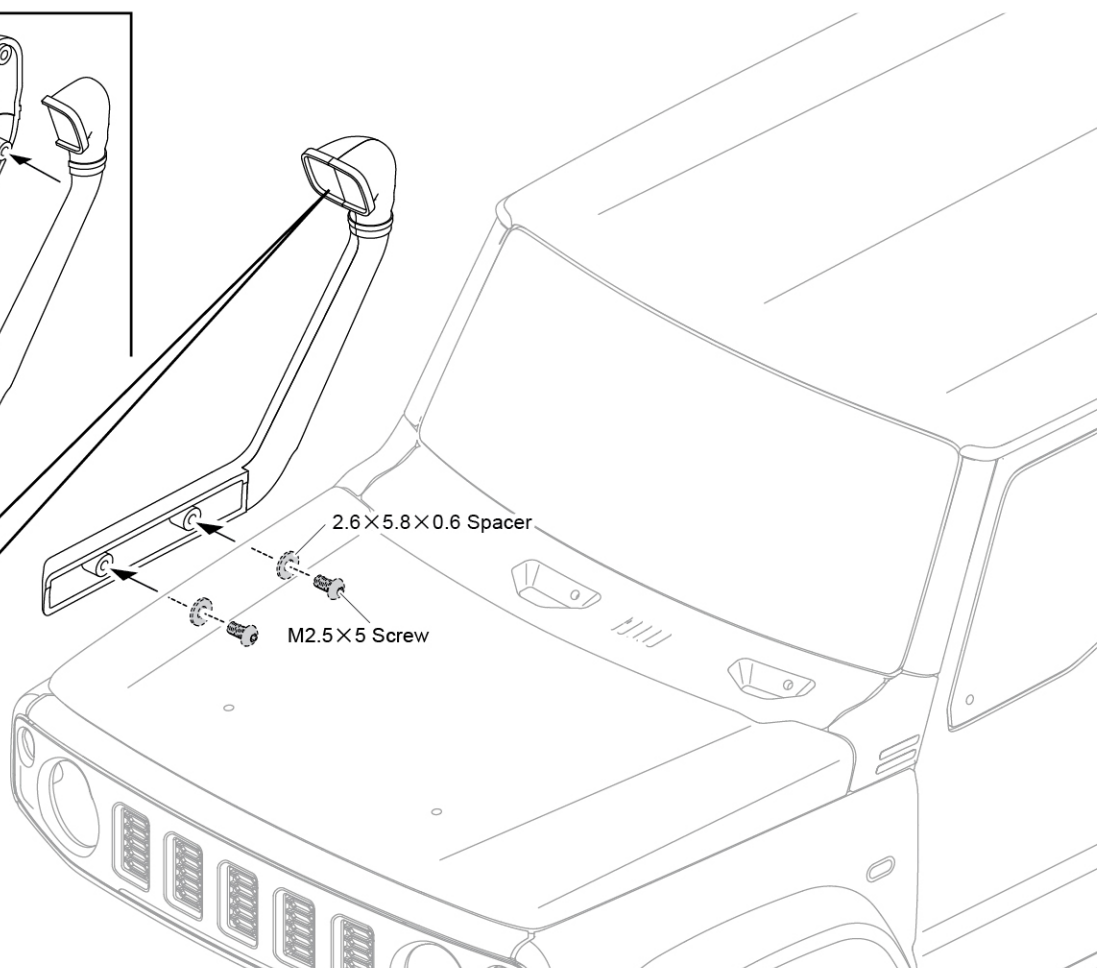
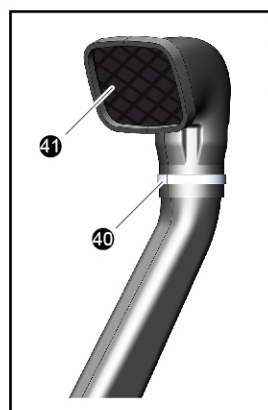
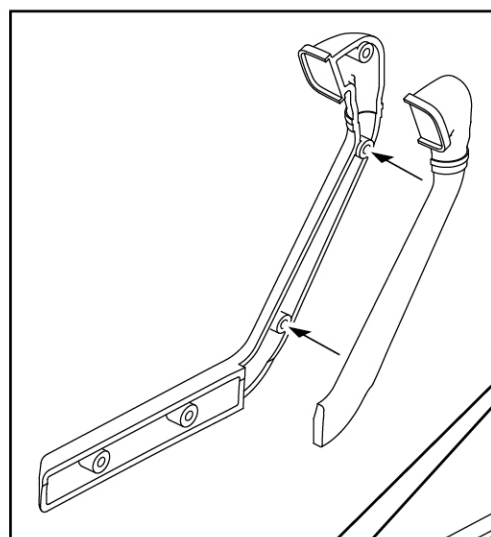
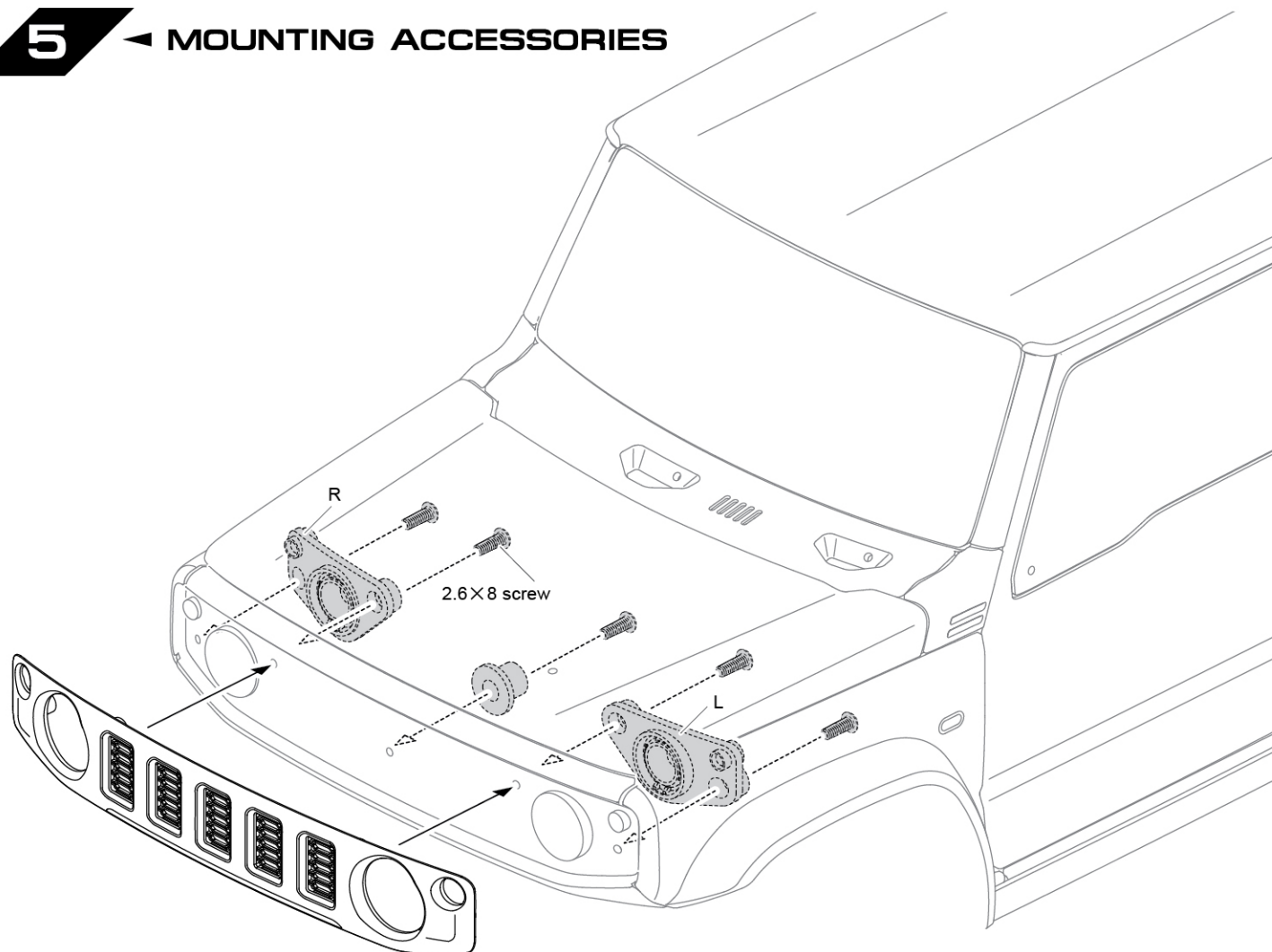

Mirror sticker

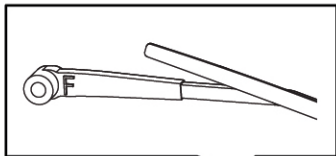
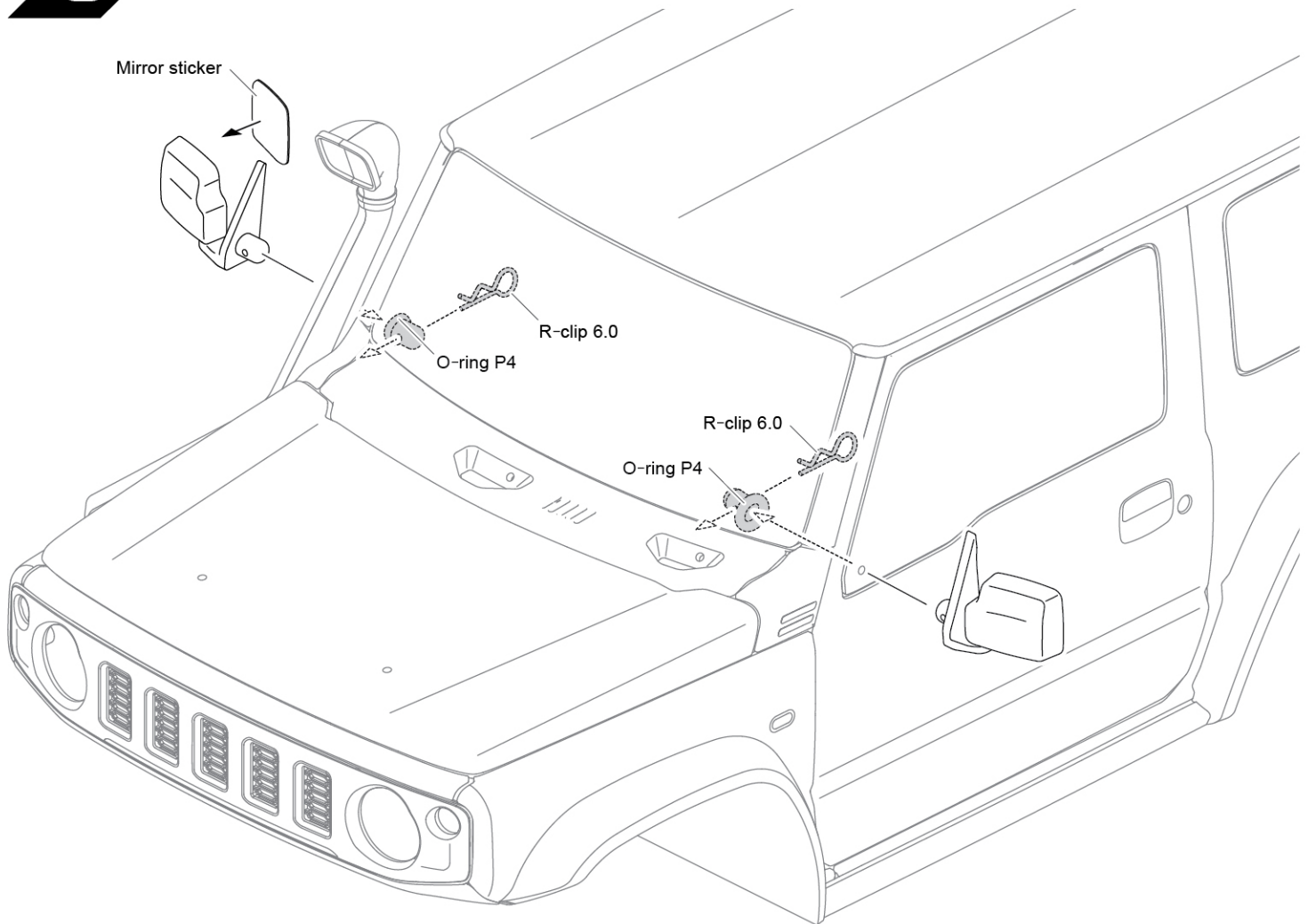

Front wiper

M2X4 Screw

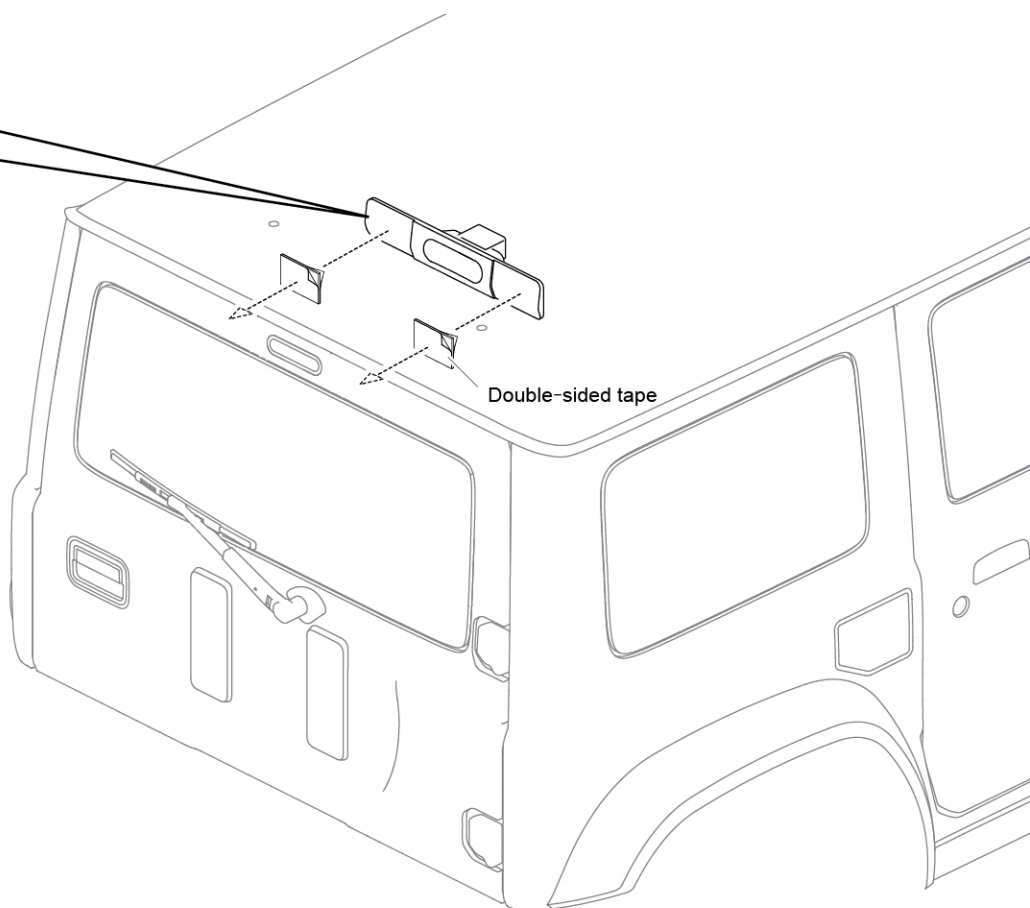
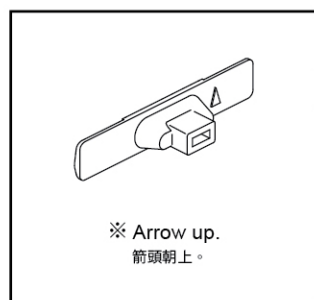
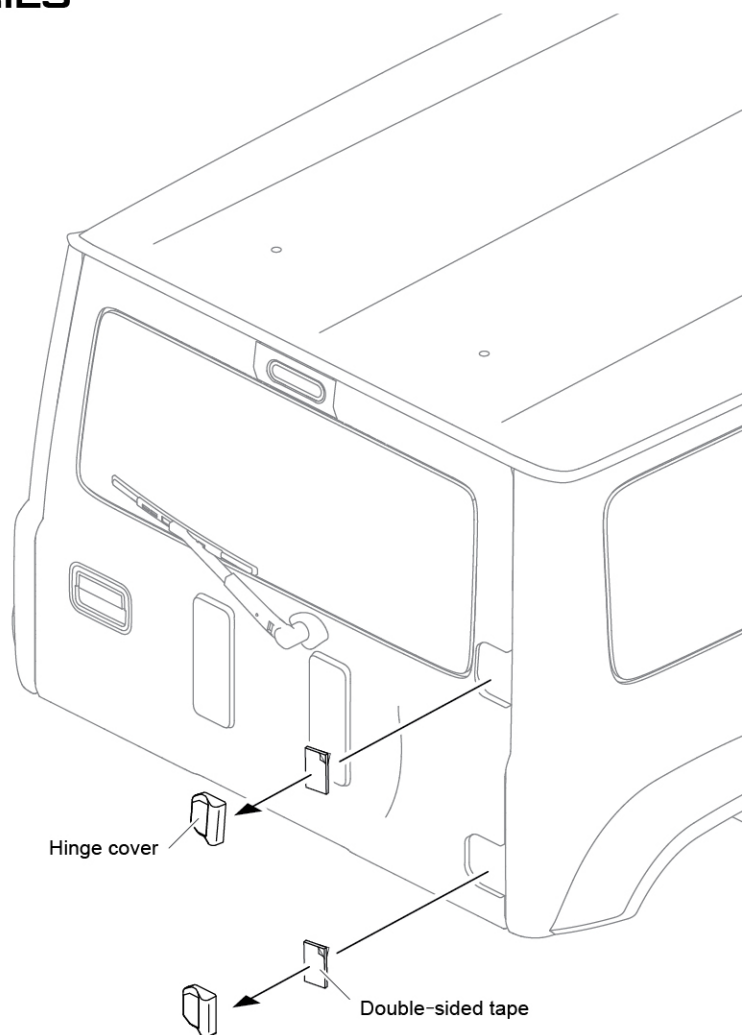
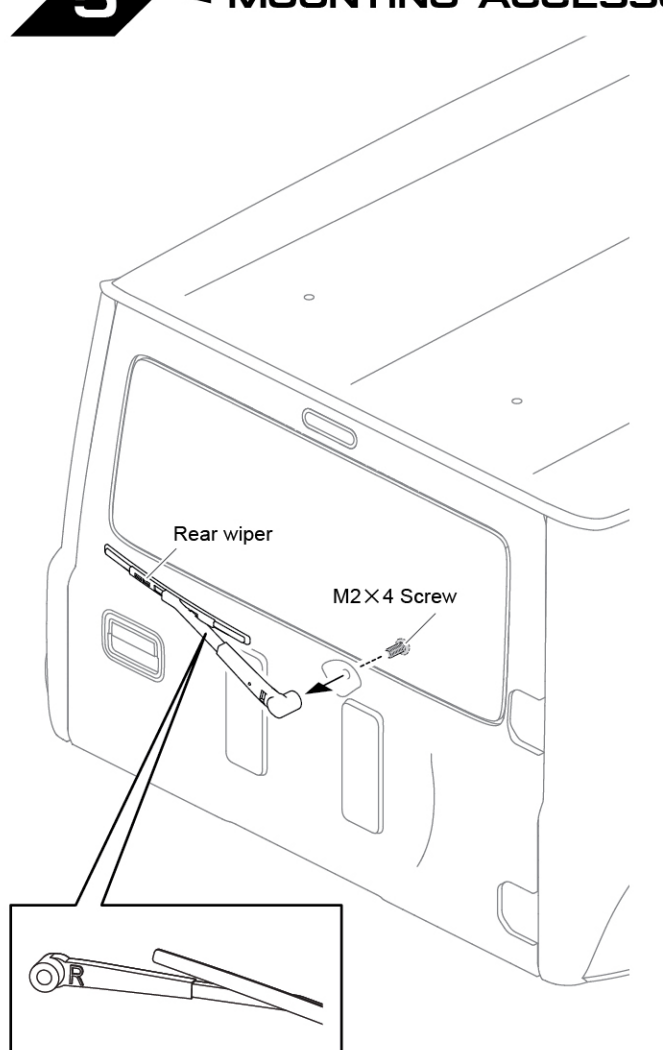

For CFX 242 wheelbase

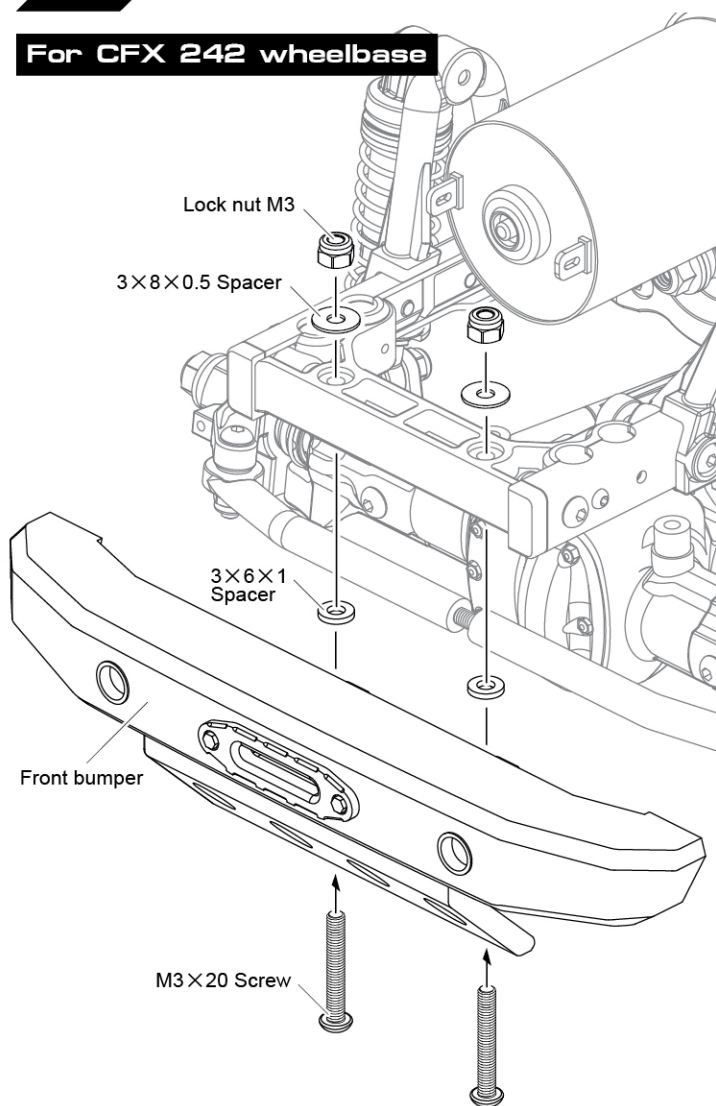

For CMX 242 wheelbase

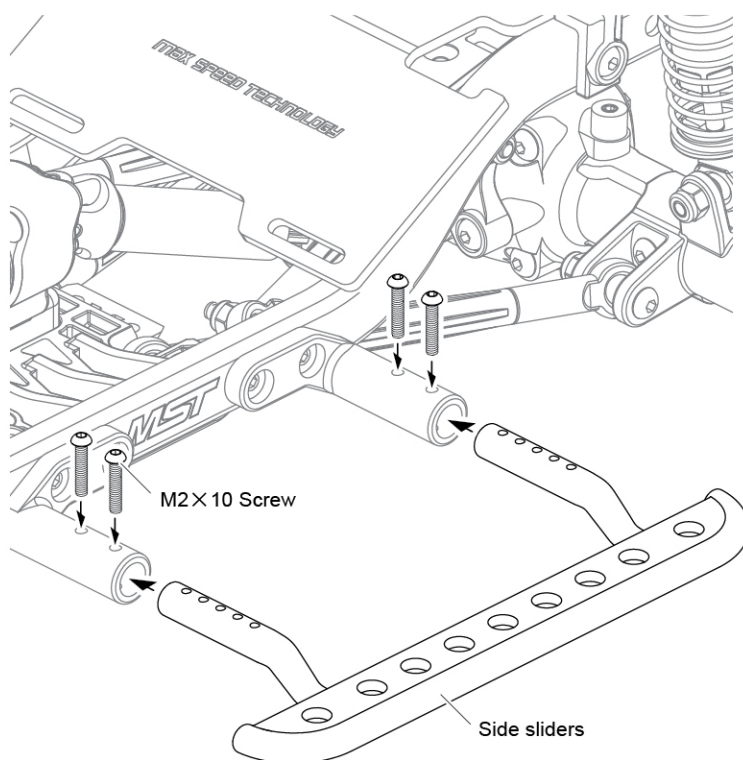
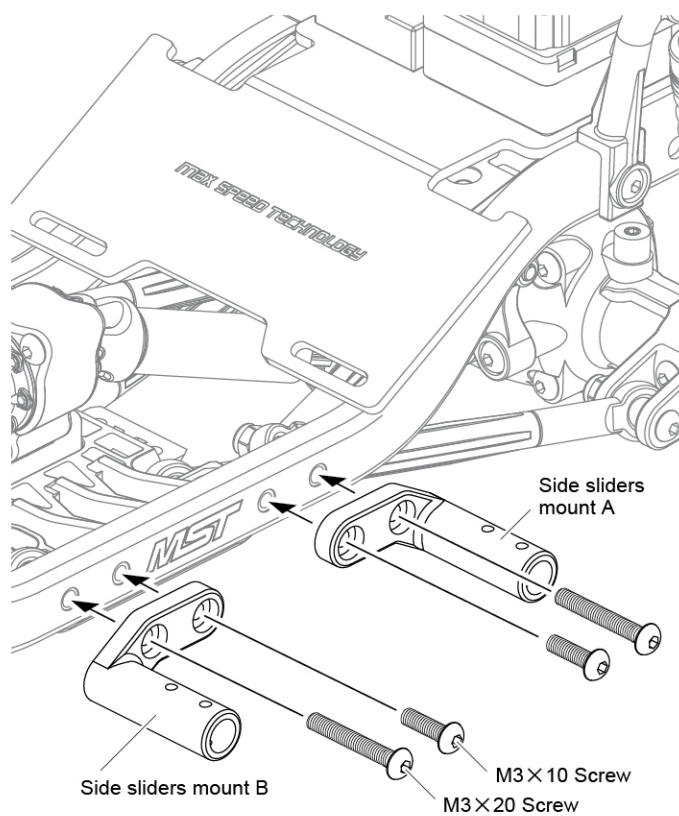
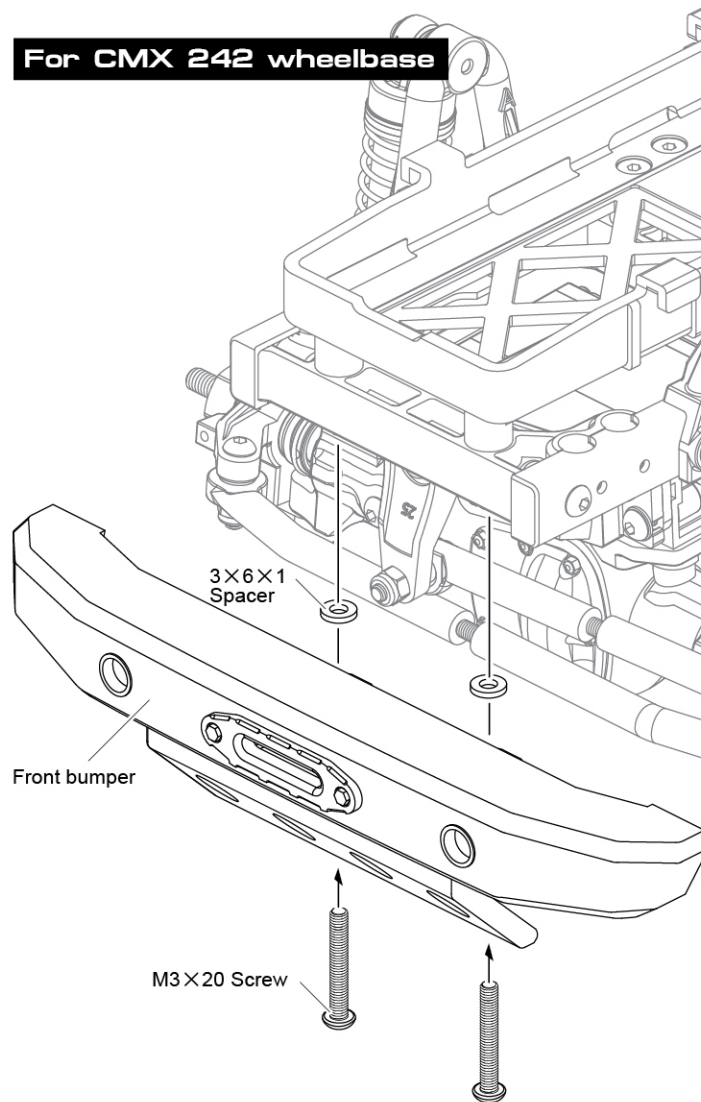

6

CHASSIS ASSEMBLY

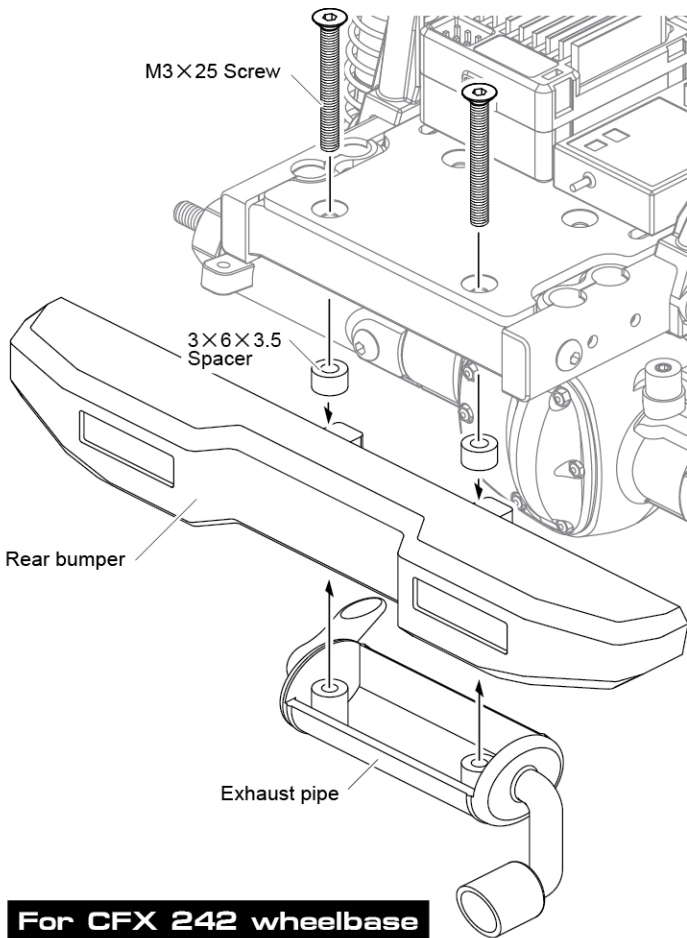
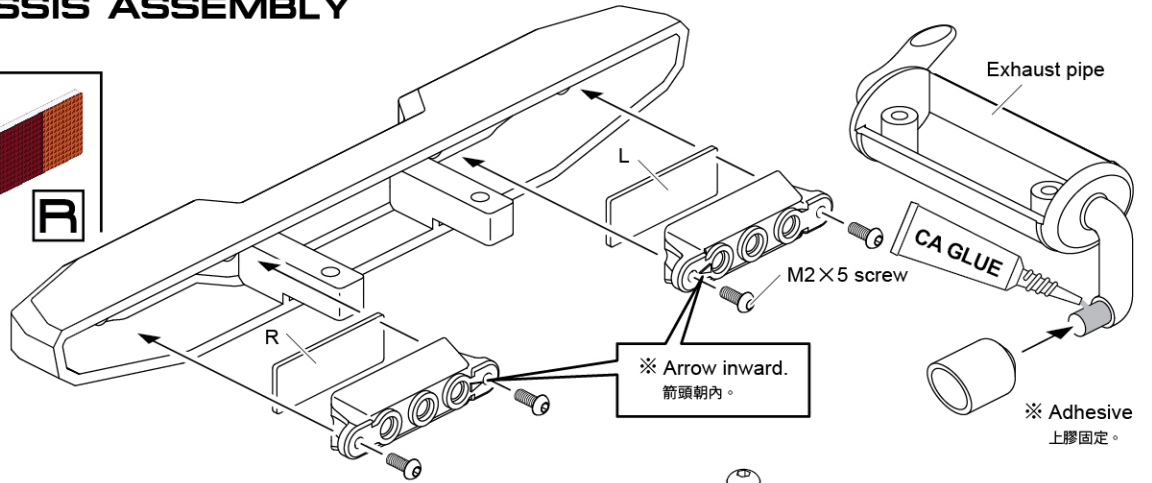
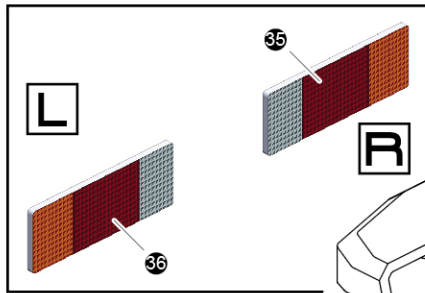

For CFX 242 wheelbase

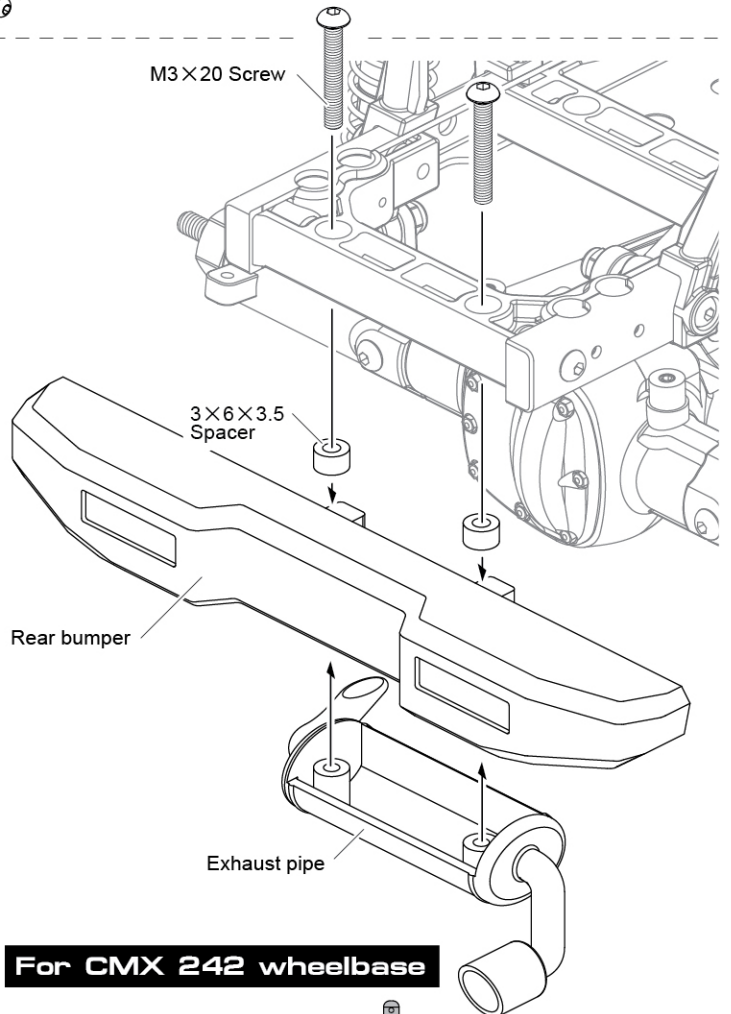

For CMX 242 wheelbase

7

ATTACHING BODY

