

ADDENDUM For Final Assembly

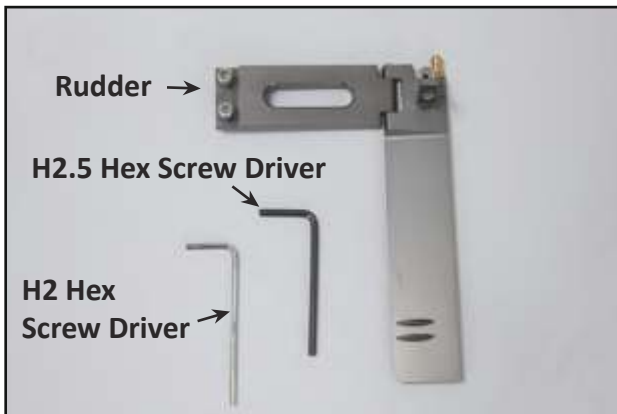

The rudder for the Velocity arrives unassembled in a separate plastic bag.



To get started, place the rudder into place on the bracket mount as shown above.

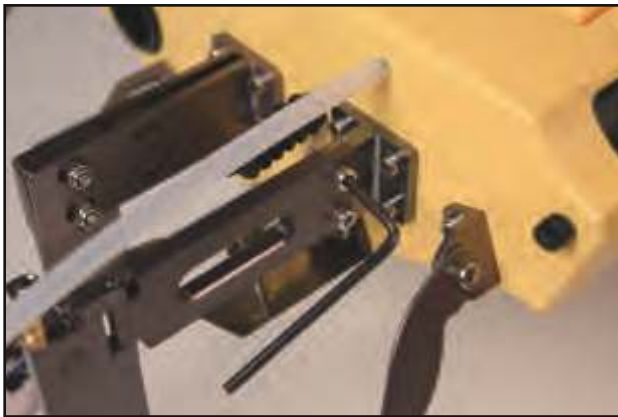

Secure the rudder to the mount by using the H2.5 hex screwdriver to tighten both screws.



Extend the water-cooling tube out of the hull and attach to the nipple at the top of the rudder.



Plug the battery (not included) to the power system and make sure the servo is in neutral position. Then insert the push rod through the nut on the arm of the rudder and tighten using the H2 screwdriver.



The rudder is now properly installed and ready for boating.